

仅供参考

| | | |
|------|-----------------|------------|
| REV. | REVISION RECORD | DATE |
| A0 | 新图面发行 | 2017.06.16 |

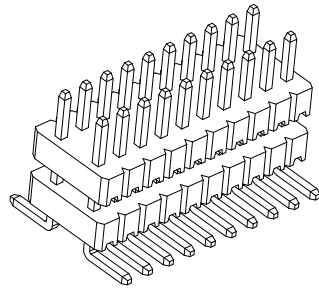

Specification:
 Current Rating : 0.75AMP
 Temperature Range : -40°C to +105°C
 Contact Resistance : 30mΩ Max
 Insulation Resistance : 500MΩ Min
 Withstanding Voltage : AC 500V
 Material:
 Insulator : Polyester (UL94V-0)
 Standard: PA6T/LCP
 Contact: Brass
 Plating : Au or Sn Over 50u" Ni

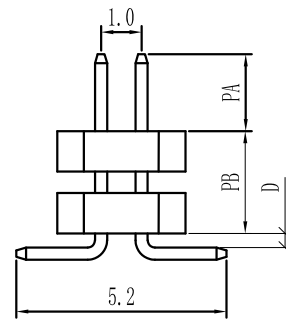
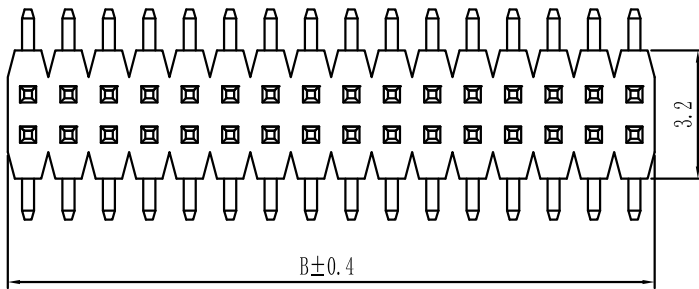

| |
|---------|
| Height |
| H=1.0mm |
| H=1.5mm |

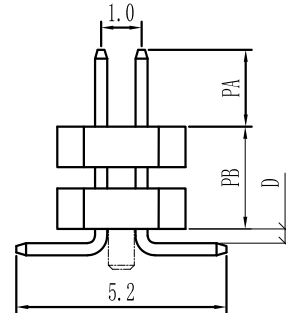
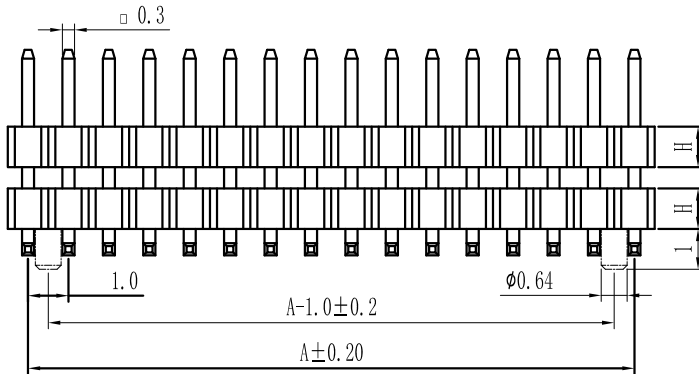

| Pin数 | 尺寸A | 尺寸B |
|------|------|------|
| 2x2 | 1.0 | 2.0 |
| 2x3 | 2.0 | 3.0 |
| 2x4 | 3.0 | 4.0 |
| 2x5 | 4.0 | 5.0 |
| 2x6 | 5.0 | 6.0 |
| 2x7 | 6.0 | 7.0 |
| 2x8 | 7.0 | 8.0 |
| 2x9 | 8.0 | 9.0 |
| 2x10 | 9.0 | 10.0 |
| 2x11 | 10.0 | 11.0 |
| 2x12 | 11.0 | 12.0 |
| 2x13 | 12.0 | 13.0 |
| 2x14 | 13.0 | 14.0 |
| 2x15 | 14.0 | 15.0 |
| 2x16 | 15.0 | 16.0 |
| 2x17 | 16.0 | 17.0 |
| 2x18 | 17.0 | 18.0 |
| 2x19 | 18.0 | 19.0 |
| 2x20 | 19.0 | 20.0 |
| 2x21 | 20.0 | 21.0 |
| 2x22 | 21.0 | 22.0 |
| 2x23 | 22.0 | 23.0 |
| 2x24 | 23.0 | 24.0 |
| 2x25 | 24.0 | 25.0 |
| 2x26 | 25.0 | 26.0 |
| 2x27 | 26.0 | 27.0 |
| 2x28 | 27.0 | 28.0 |
| 2x29 | 28.0 | 29.0 |
| 2x30 | 29.0 | 30.0 |
| 2x31 | 30.0 | 31.0 |
| 2x32 | 31.0 | 32.0 |
| 2x33 | 32.0 | 33.0 |
| 2x34 | 33.0 | 34.0 |
| 2x35 | 34.0 | 35.0 |
| 2x36 | 35.0 | 36.0 |
| 2x37 | 36.0 | 37.0 |
| 2x38 | 37.0 | 38.0 |
| 2x39 | 38.0 | 39.0 |
| 2x40 | 39.0 | 40.0 |
| 2x41 | 40.0 | 41.0 |
| 2x42 | 41.0 | 42.0 |
| 2x43 | 42.0 | 43.0 |
| 2x44 | 43.0 | 44.0 |
| 2x45 | 44.0 | 45.0 |
| 2x46 | 45.0 | 46.0 |
| 2x47 | 46.0 | 47.0 |
| 2x48 | 47.0 | 48.0 |
| 2x49 | 48.0 | 49.0 |
| 2x50 | 49.0 | 50.0 |

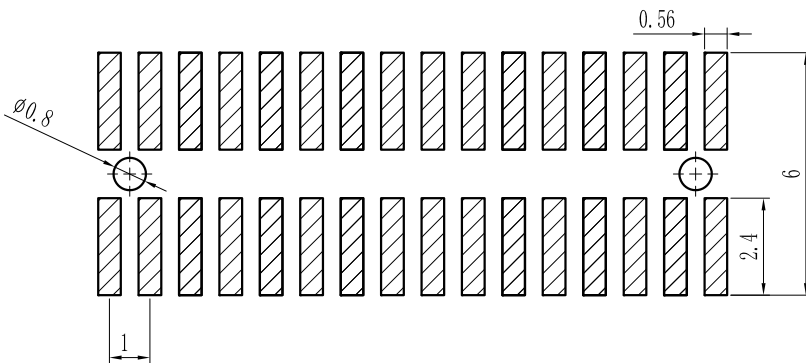

PCB LAYOUT

| | | | | | | | | |
|----------|--------------------|-----------|---------------|------|------------|--|-----------------------------|----------|
| | GENERAL TOLERANCES | | SCALE: 1:1 | NAME | DATE | 深圳市思拓展电子有限公司 SHENZHEN SINOTOP ELECTRONICS CO.,LTD 公司网址: www.szsituo.cn 公司电话: 0755-23765350 邮 箱: 2850175982@qq.com 公司传真: 0755-23765341 | PART. NO: ST-PH-100-0015 | |
| | LINEAR | ANGLES | | | | | APPROVED | DWG. NO: |
| UNIT: MM | 0.0±0.30 | X° REF±6° | DESIGNER | | | TITLE: | REV: A0 | |
| SIZE: A4 | 0.000±0.10 | X° X'±2° | DRAWN | 肖坤权 | 2017.06.16 | Pitch1.0mm Pin Header, Dual Plastic, Dual Row, SMT Type | SHEET: 1/1 | |