

仅供参考

| | | |
|------|-----------------|------------|
| REV. | REVISION RECORD | DATE |
| A0 | 新图面发行 | 2017.06.16 |

主要技术参数 Main Specifications

线 数 (Poles): 02 to 24
 接触电阻 (Contact resistance): $\leq 20m\Omega$
 绝缘电阻 (Insulation resistance): $\geq 1000M\Omega$
 额定电压 (Rated voltage): 250V AC DC
 额定电流 (Rated current): 2.5A AC DC
 耐 电压 (Withstand Voltage): 1000V AC/minute
 温度范围 (Temperature Range): $-25^{\circ}C \sim +85^{\circ}C$

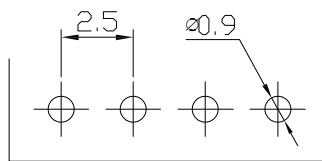
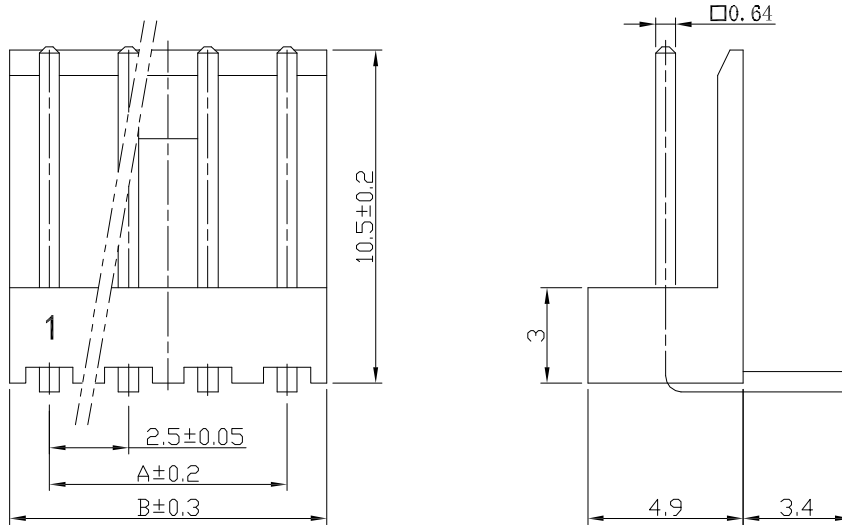
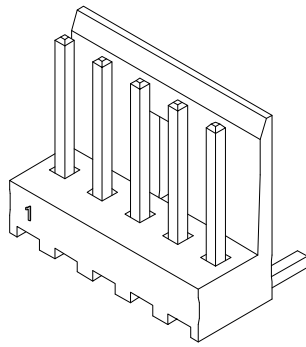

P. C. B LAYOUT

| Poles | Dimensions mm | |
|-------|---------------|-------|
| | A | B |
| 2 | 2.50 | 5.00 |
| 3 | 5.00 | 7.50 |
| 4 | 7.50 | 10.00 |
| 5 | 10.00 | 12.50 |
| 6 | 12.50 | 15.00 |
| 7 | 15.00 | 17.50 |
| 8 | 17.50 | 20.00 |
| 9 | 20.00 | 22.50 |
| 10 | 22.50 | 25.00 |
| 11 | 25.00 | 27.50 |
| 12 | 27.50 | 30.00 |
| -- | -- | -- |
| 24 | 57.50 | 60.00 |

| | | | | |
|------|-----------|-------|----------|-------------|
| B | CONTACT | n PCS | Brass | Tin-plated |
| A | PEDESTAL | 1 PCS | PA66 | COLOR:WHITE |
| ITEM | COMPONENT | Q'TY | MATERIAL | FINISH |

| | | | | | | | |
|----------|--------------------|-----------|---------------|------|------------|--|------------------------------|
| | GENERAL TOLERANCES | | SCALE: 1:1 | NAME | DATE | 深圳市思拓展电子有限公司 SHENZHEN SINOTOP ELECTRONICS CO., LTD 公司网址: www.szstuo.cn 公司电话: 0755-23765350 邮 箱: 2850175982@qq.com 公司传真: 0755-23765341 | PART. NO: ST-WF-250-010AW |
| | LINEAR | ANGLES | | | | | |
| UNIT: MM | 0.0±0.30 | X° REF±6° | DESIGNER | | | TITLE: | DWG. NO: |
| SIZE: A4 | 0.00±0.10 | X° X'±2° | DRAWN | 肖坤权 | 2017.06.16 | 2.50mmPITCH 90° WAFER DIP TYPE | REV: A0 SHEET: 1/1 |

仅供参考

| | | |
|------|-----------------|------------|
| REV. | REVISION RECORD | DATE |
| A0 | 新图面发行 | 2017.06.16 |

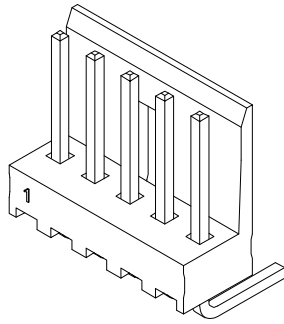

主要技术参数 Main Specifications

线 数 (Poles): 02 to 24
 接触电阻 (Contact resistance): $\leq 20m\Omega$
 绝缘电阻 (Insulation resistance): $\geq 1000M\Omega$
 额定电压 (Rated voltage): 250V AC DC
 额定电流 (Rated current): 2.5A AC DC
 耐 电 压 (Withstand Voltage): 1000V AC/minute
 温度范围 (Temperature Range): $-25^{\circ}C \sim +85^{\circ}C$

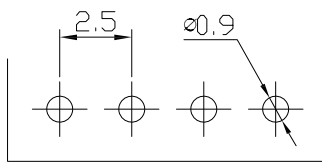
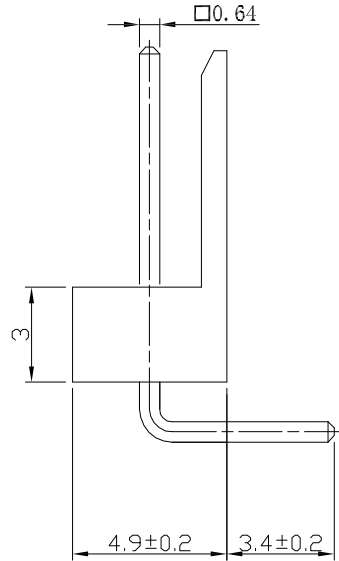
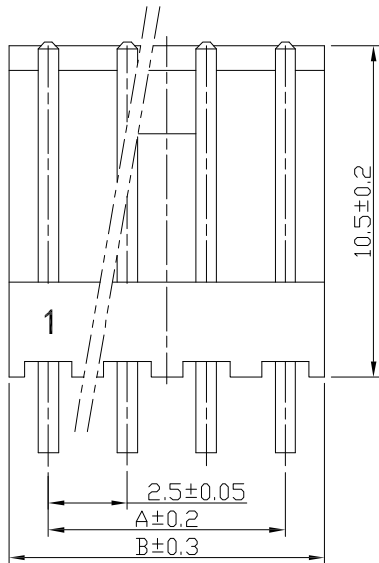

P. C. B LAYOUT

| Poles | Dimensions mm | |
|-------|---------------|-------|
| | A | B |
| 2 | 2.50 | 5.00 |
| 3 | 5.00 | 7.50 |
| 4 | 7.50 | 10.00 |
| 5 | 10.00 | 12.50 |
| 6 | 12.50 | 15.00 |
| 7 | 15.00 | 17.50 |
| 8 | 17.50 | 20.00 |
| 9 | 20.00 | 22.50 |
| 10 | 22.50 | 25.00 |
| 11 | 25.00 | 27.50 |
| 12 | 27.50 | 30.00 |
| -- | -- | -- |
| 24 | 57.50 | 60.00 |

| ITEM | COMPONENT | Q'TY | MATERIAL | FINISH |
|------|-----------|-------|----------|-------------|
| B | CONTACT | n PCS | Brass | Tin-plated |
| A | PEDESTAL | 1 PCS | PA66 | COLOR:WHITE |

| | | | | | | | |
|----------|--------------------|-----------|---------------------------------------|-------|------|--|------------------|
| | GENERAL TOLERANCES | | SCALE: 1:1 | NAME | DATE | 深圳市思拓展电子有限公司 SHENZHEN SINOTOP ELECTRONICS CO., LTD 公司网址: www.szstuo.cn 公司电话: 0755-23765350 邮 箱: 2850175982@qq.com 公司传真: 0755-23765341 | PART. NO: |
| | LINEAR | ANGLES | APPROVED | | | | ST-WF-250-010AWG |
| | 0.0±0.30 | X° REF±6° | DESIGNER | | | | DWG. NO: |
| | UNIT: MM | 0.00±0.20 | X° ±3° | DRAWN | 肖坤权 | | 2017.06.16 |
| SIZE: A4 | 0.000±0.10 | X° X'±2° | TITLE: 2.50mmPITCH 90° WAFER DIP TYPE | | | | |